

A Reputation Built on Convenience and Reliability

PS-3206S | 3204S

New



DGI's Ideal Solution for High Quality Wide Fo

TECH 1

Precision Take-up System

A newly developed take-up reel system provides greater stability during printing. More uniform media feeding results in higher image quality and trouble free unattended operation. It also makes loading new media a snap.

TECH 2

Automated Maintenance System

Automated cleaning system prevents nozzle clogging which translates into longer print head life, better image quality and reliable unattended operation.

TECH 3

Roll Type Tension Bar

Precise roll type tension bar maintains even tension while printing and eliminates distortion of media.



GENERAL FEATURES

Exceptional Print Speed

Combining print quality with high speed printing using Spectra printheads.

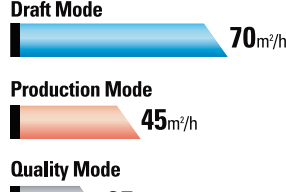

Proprietary Dot Control System

-DGI's Drop Control Technology is a new world standard in the control of dot alignment
-Prevents satellites for more vivid color and enhanced print quality

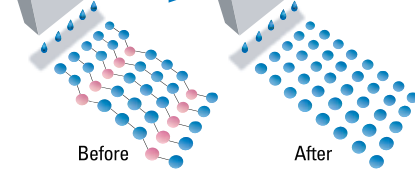

Compatible Ink[S800]

Type: Solvent
Volume/Bottle: 4L
Color: C, M, Y, K, Lc, Lm and Cleaning Solution
Package: 4 Bottles/Box
Printer Compatibility: PS Series, MJ Series



Format Printing

DGI, Korea's leading ink jet printer manufacturer, is proud to introduce new model enhancements to the POLAJET Series of printers. POLAJET printers are the perfect partner for any size print shop, offering the best combination of image quality, speed and media compatibility. POLAJET printers are easy to install and maintain; exceeding expectations of demanding print experts everywhere.

Speed

Draft Mode
70m²/hr

Resolution

MAX
720dpi

Print Width

MAX
3.2m

Print Head

PS-3206S
6 color 6 head
PS-3204S
4 color 4 head



POLAJET
PS-3206S
PS-3204S

● FRONT ○ REAR

Designed with the CUSTOMER IN MIND



Drum Type Feeding

The superior drum type feeding roller maintains even tension while printing and eliminates media distortion.

Roll Type Tension Bar

Maintains even tension while printing. Eliminates distortion of media.

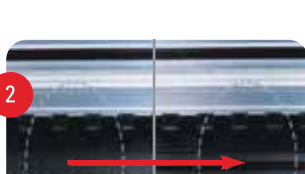

Mesh Print Function

Our easy to change platen allows you to use a variety of media. (mesh or vacuum)



Pneumatic Pump

Our integrated pump maintains negative pressure without you spending money on compressors. And, there's less noise.



The Industry's Easiest to Use Ink Supply System

Our easy access ink drawer features ink level gauges and windows. Checking ink levels is easy and refills are fast and clean.

Different & Better!

Aiming for the Best in the world

It's different because it comes from DGI.

DGI is meeting the challenge of becoming the world's No. 1 supplier of commercial IJ printers. To do this 'DGI products are simply better than any other manufacturer'.

PS-3206S/PS-3204S

Technical Specification	PS-3206S	PS-3204S
Print Speed		
Draft Mode	65~70m²/hr(700~754ft²/h)	65~70m²/hr(700~754ft²/h)
Production Mode	35~45m²/hr(377~484ft²/h)	35~45m²/hr(377~484ft²/h)
Quality Mode	20~25m²/hr(215~269ft²/h)	20~25m²/hr(215~269ft²/h)
Resolution	720dpi	720dpi
Max Print Width	3,250mm(128") / Print Margins 5mm(0.2")	3,250mm(128") / Print Margins 5mm(0.2")
Max Media Width	3,300mm(130")	3,300mm(130")
Memory	FPGA: 24MB / PC: 512MB	FPGA: 24MB / PC: 512MB
Media		
Handling	Roll to sheet	Roll to sheet
Type	Flex, Banner, Vinyl etc.	Flex, Banner, Vinyl etc.
Head Height	2.5mm(0.1")	2.5mm(0.1")
Thickness	0.2mm~0.6mm(0.01~0.02")	0.2mm~0.6mm(0.01~0.02")
Max Weight	100kgs(220.5lbs)	100kgs(220.5lbs)
Printhead Technology		
No. of Printhead	6	4
Technology	DOD Piezo electric Inkjet Head	DOD Piezo electric Inkjet Head
Ink Type	Solvent Ink(C, M, Y, K, Lc, Lm)	Solvent Ink(C, M, Y, K)
Heater	Front Max 50℃(122°F) Rubber Roll 45℃(113°F) Drying Lamp: 60 ~ 80℃(140~176°F) / Option	Front Max 50℃(122°F) Rubber Roll 45℃(113°F) Drying Lamp: 60 ~ 80℃(140~176°F) / Option
Interface	TCP/IP	TCP/IP
Dimension		
Uncrated	5,020mm × 1,050mm × 1,800mm (197.6" × 41.3" × 70.9")	5,020mm × 1,050mm × 1,800mm (197.6" × 41.3" × 70.9")
Crated	5,340mm × 1,540mm × 2,290mm (210.2" × 60.6" × 90.2")	5,340mm × 1,540mm × 2,290mm (210.2" × 60.6" × 90.2")
Weight	1,800kg(3,960 lbs)	1,800kg(3,960 lbs)
Environmental Ranges		
Recommended Operating Temperature	20~30℃(68~86°F)	20~30℃(68~86°F)
Recommended Humidity Range	30~80%	30~80%
Power Requirements	Single Phase 220V 25A	Single Phase 220V 25A
Certification	CE, FCC, KCC	CE, FCC, KCC

The above specification is subject to being changeable without prior notice for some improvement.